

Pedestals model 6680/81



| model | A (mm/inch) | B (mm/inch) | C (mm/inch) |
|-------|-------------|-------------|-------------|
| 6680 | 740 29" | 440 17" | 660 26" |
| 6681 | 740 29" | 510 20" | 510 20" |

Customized piston extension (OPTIONAL). On-board fixing with 2 knobs.
Simple version without gas piston without extension; without rotation or fixed without adjustment possibility (OPTIONAL).
NOTE: The fastening screws (countersunk M8) and the knobs are not included in the base.

LEAD TIME TO BE CONFIRMED

Model 6680

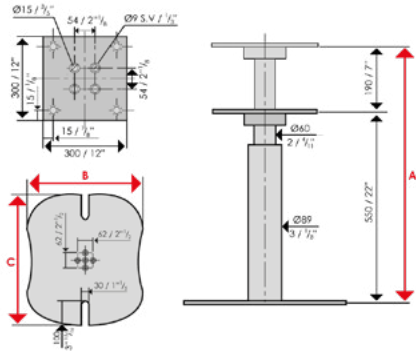

Model 6681

